



Manual Bilge Pumps

Gusher® 30 Pump

On Deck: BP3000, On Bulkhead: BP3010, Thru Deck: BP3020

Largest Capacity Manual Bilge Pump in the Whale Range



CURRENT MODEL

Note* Contained in Service Kit AK3051

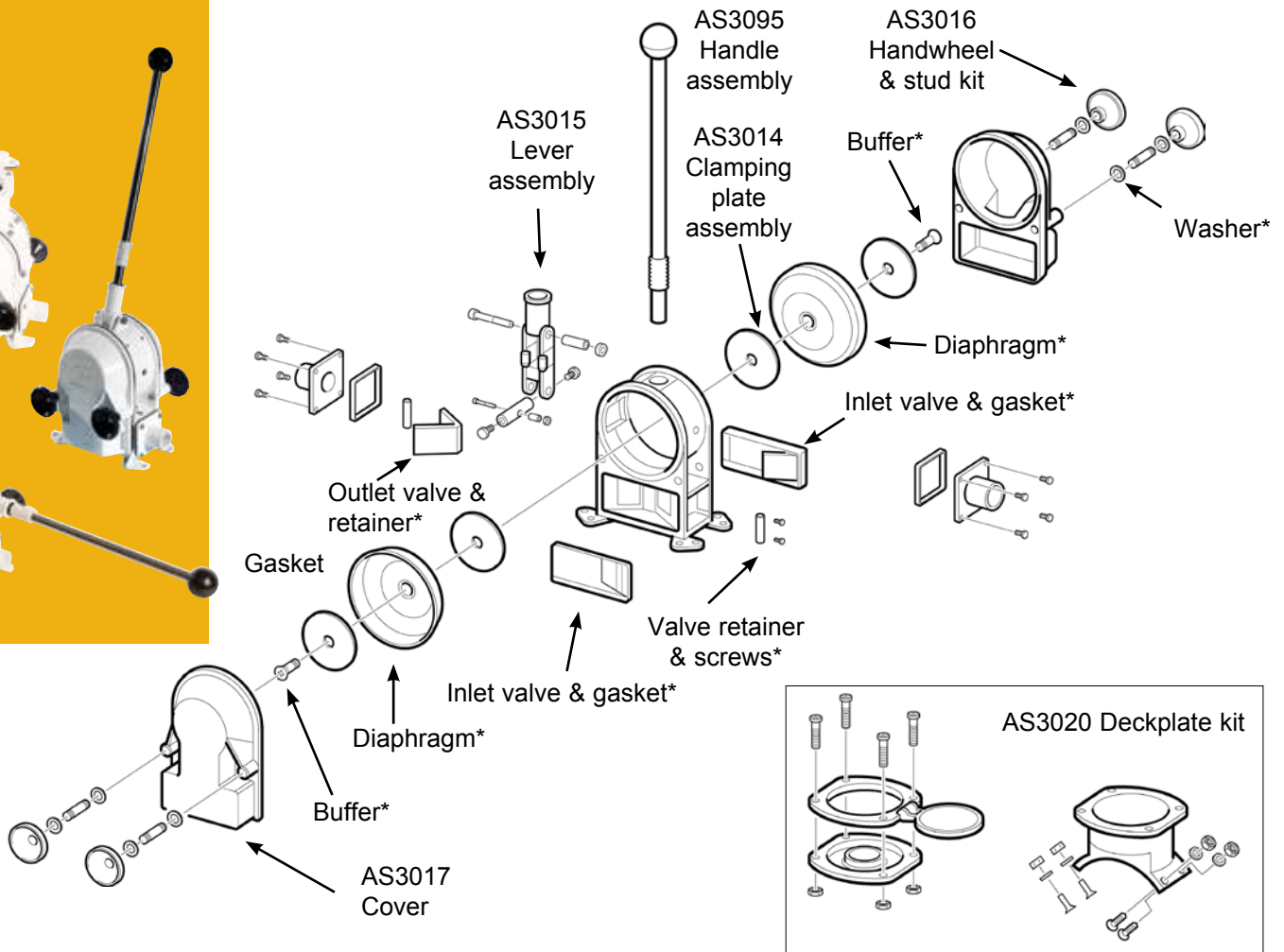

Accessories

AS3020 Deckplate Kit Assembly

AS3095 Spare Handle

DP3804 Deckplate

Service Kits

AK3051 Service Kit of Serviceable Parts for Whale Gusher® 30

Qty	Containing
2	Screw No 6x1 1/4"
2	Diaphragm
2	Inlet valve & gasket
1	Outlet valve
2	Valve retainer
2	Valve chamber gasket
4	Washer nylon M10
2	Buffer

AS3015 Lever Assembly

Qty	Containing
1	Fork insert
1	Lever
2	Lever bush
2	Buffer
1	Nylon nut M6
1	Nylon nut M8
2	Clamping screw
1	Connecting rod
1	Connecting rod bush
1	Lever bush
1	Lever fulcrum bolt
1	Body fulcrum bolt

AS3016 Handwheel & Stud Kit

Qty	Containing
2	Nylon nut M8
2	Stud
2	Washer nylon M10
2	Hand wheel nut

AS3017 Cover Gusher® 30

Qty	Containing
1	Cover



Manual Bilge Pumps

Gusher® 30 Pump

On Deck: BP3000, On Bulkhead: BP3010, Thru Deck: BP3020

Largest Capacity Manual Bilge Pump in the Whale Range



AK3051



AS3014



AS3015



AS3016



AS3017



AS3020



AS3095



AS3725



DP3804

Service Kits (Continued)

AS3725 Gaiter Kit for Deckplates

Qty	Containing
1	Gaiter (for metal or plastic deckplate)
1	O-ring (for metal deckplate)

AS3020 Deckplate Kit Assembly

Qty	Containing
4	Nut M6
1	Lid
1	Deckplate
1	O-ring (deckplate lid)
1	Nyloc nut M6
1	Gaiter
1	Underdeck bracket
4	Screw HEX HD M6x20
4	Screw M6x50

AS3014 Clamping Plate Kit

Qty	Containing
4	Clamping plates
2	Clamping screws
2	Buffers

AS3095 Handle Assembly (Standard) s/s 450mm